



IQ4 - Metal Detection Head

Designed for Food & Packaging Industries

The New IQ4 series of variable-frequency detection search heads are designed to inspect products for metal contaminants in the food and packaging Industries. They can be purchased as a search head that can be integrated into a larger packaging line or as a standalone conveyor unit with automatic reject stations.

Product Highlights

- Auto-Learn feature rapidly delivers good detection sensitivities out of the box and provides more line uptime than ever before
- Variable-frequency detection (31KHz to 882KHz)
- Full range of aperture sizes to suit products being inspected
- Multiple product memories for rapid product change over and data storage
- DDS vector display delivers perfect production setups
- Multilevel password protection provides secure access



7" Colour Touchscreen

Standard across all of the IQ4 range, the big 7" touchscreen offers 33% more space than previous generation metal detectors making operations simple.

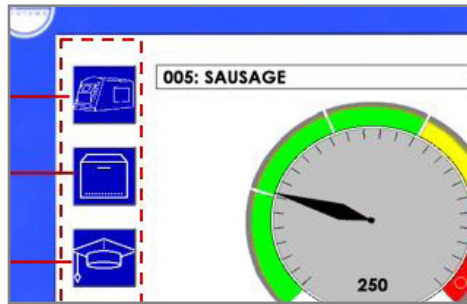

Engaging User Interface

The newly designed interface provided across the entire range makes light work of setting, running and maintaining the IQ4 range and minimizes user errors



Robust IP69K Rating

An improved lip, screen, and new blue sealing arrangement, combined with ultra-harsh mechanics proven from the IQ3+ range, make this one of the toughest and factory-friendly metal detectors on the market



Technical Specification

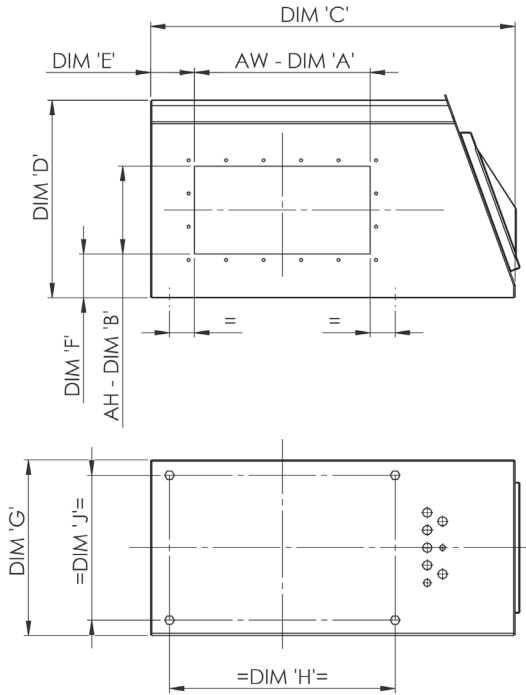

Material of Construction	304 Brushed stainless steel
True Variable Frequency	31KHz to 882KHz
Supply Voltages	85 to 265 V, 1 ph 50.60 Hz, neutral & Earth
Power Consumption	20VA
Temperature Range	-10°C TO + 35°C (14°F to 95°F)
Humidity	0 to 95% Relative Humidity (Non-condensing)
Environment	IP69K
PVS Enabled	Yes
Ethernet Capability	Yes
USB Capability	Yes

Head Dimensions

Dimension A = Aperture Width
Dimension B = Aperture Height

Dim's																				
B	75	100	125	150	175	200	225	250	275	300	325	350	375	400	425	450	475	500	525	550
C	AW + 430	AW + 430	AW + 430	AW + 430	AW + 430	AW + 430	AW + 430	AW + 430	AW + 530	AW + 530	AW + 530	AW + 530	AW + 670	AW + 670	AW + 670	AW + 670	AW + 810	AW + 810	AW + 810	AW + 810
D	392,5	392,5	392,5	400	425	450	475	500	625	650	675	700	825	850	875	900	1025	1050	1075	1100
E	100	100	100	100	100	100	100	100	150	150	150	150	200	200	200	200	250	250	250	250
F	142,5	130	117,5	100	100	100	100	100	150	150	150	150	200	200	200	200	250	250	250	250
G	300	300	300	300	400	400	400	400	500	500	500	500	600	600	600	600	700	700	700	700
H	AW + 114	AW + 114	AW + 114	AW + 114	AW + 114	AW + 114	AW + 114	AW + 114	AW + 114	AW + 114	AW + 114	AW + 114	AW + 114	AW + 114	AW + 114	AW + 114	AW + 114	AW + 114	AW + 114	AW + 114
J	230	230	230	230	330	330	330	330	430	430	430	430	530	530	530	530	630	630	630	630

Other Features

- Rugged construction using brushed 304 stainless steel
- Unique clam-shell designed case and coil geometry that delivers unsurpassed levels of immunity
- Extensive data logging and reporting via USB or Ethernet for HACCP and retail compliance
- 32-bit digital signal processing for enhanced contaminant detection
- Can be integrated into a conveyor system to achieve High Compliance Retail Specification



An ITW Company

www.loma.com

Tel: +44 1252 893300 (UK) | +1-800-872-LOMA (North America)

Metal Detection | Checkweighing | X-Ray Inspection

Loma Systems is a registered trademark of Illinois Tool Works Inc. (ITW). Other names, logos, icons and marks identifying our products and services referenced herein are trademarks of ITW and may not be used without the prior written permission of ITW. Other product and company names listed are trademarks or trade names of their respective companies. Copyright © 2017 Illinois Tool Works Inc. All rights reserved. All of the specifications shown in this document are subject to change without notice.

In association with

